

Front View

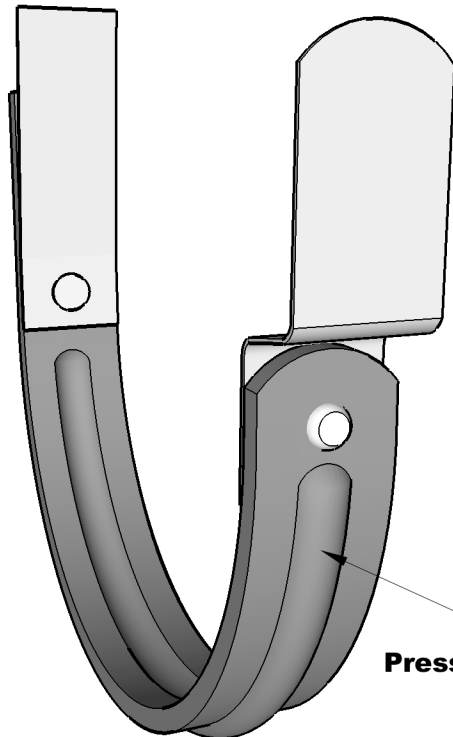

Multiple Holes
for Fastening
& Adjustments

Press Formed Stiffing Wedge

Back View

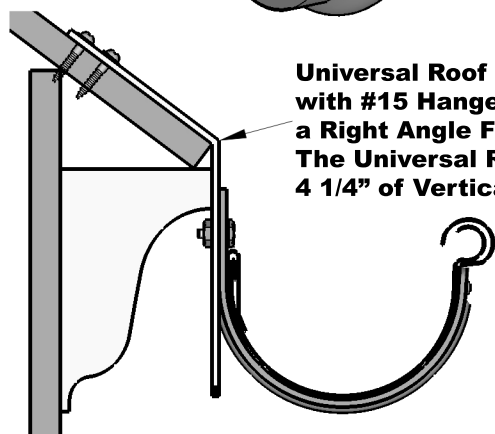
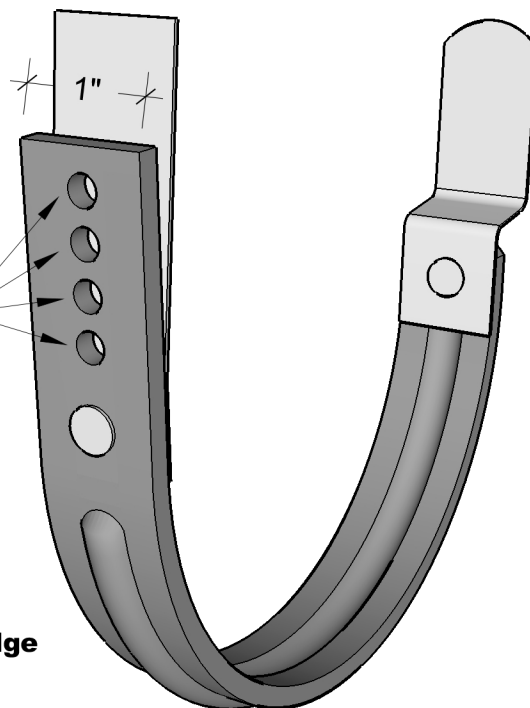

Universal Roof Mount can be used
with #15 Hanger to Install Gutter on
a Right Angle Fascia or Crown Molding
The Universal Roof Mount gives you
4 1/4" of Vertical Pitch Adjustment

Side View

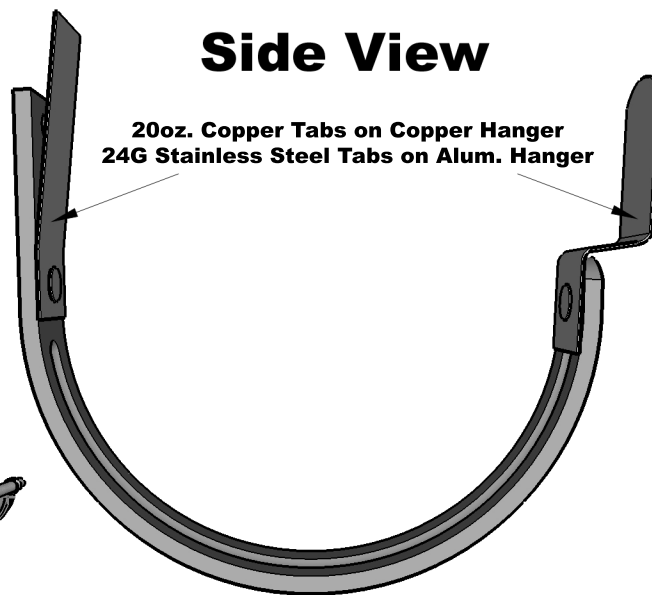

20oz. Copper Tabs on Copper Hanger
24G Stainless Steel Tabs on Alum. Hanger

Mount Directly to a Plumb Fascia Board.

Fold over Tabs Secure Gutter in Place

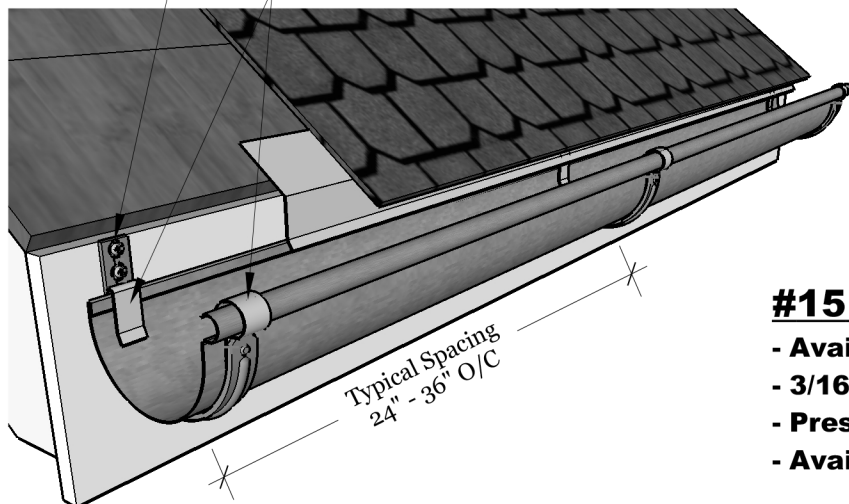

Typical Spacing
24" - 36" O/C

#15 Hanger for Half Round Gutter

- Available for 5", 6", & 8" Half Round Gutter
- 3/16" x 1" Heavy Duty Bar Stock
- Pressed Formed Bracket w/ Stiffing Wedge
- Available in Copper or Alum. Paint to Match

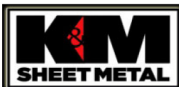

1310 E. Cornwallis Rd.
Durham, NC 27713
P-(919) 544-8887 F- 544-8898

info@kmsheetmetal.com - www.kmsheetmetal.com

#15 HANGER

HALF ROUND GUTTER

REVISIONS

MM/DD/YY	REMARKS
1 9/08/2015	...ORIGINAL DRAFT OF DRAWING
2	...
3	...
4	...
5	...

D 001